

SETTING OUT DETAILS FOR SEWERS							
MANHOLE No.	COORDINATE Y	COORDINATE X	COVER LEVEL	INVERT LEVEL	DEPTH (m)	DISTANCE (m)	GRADE
FS1	19284.885	3758270.847	121.864	120.314	1.550	66.36	1:144.1
FS2	19288.890	3758262.797	119.316	119.775	1.539	86.87	1:118.15
FS3	19300.498	3758254.770	119.889	117.740	1.950	88.87	1:243.15
FS4	19314.499	3758246.761	118.771	116.711	1.980	71.53	1:243.15
FS5	19328.500	3758238.752	117.654	115.654	1.995	65.98	1:304.34
FS6	19342.501	3758230.743	116.537	114.597	1.940	80.53	1:152.26
FS7	19356.502	3758222.734	115.420	113.540	1.930	80.53	1:172.25
FS7A	19368.240	3758210.314	113.969	112.584	1.375	36.99	1:294.31
FS8	19384.820	3758204.442	113.888	112.008	1.880	48.72	1:311.50
FS9	19398.408	3758198.570	110.898	109.971	1.026	49.01	1:114.46
FS10	19394.500	3758203.287	109.891	107.135	1.255	46.32	1:304.46
FS12	19408.600	3758204.710	107.499	105.749	1.700	49.01	1:114.46
FS11	19416.848	3758199.901	110.422	108.961	1.465	53.51	1:105.79
FS12	19428.800	3758202.710	107.305	105.740	1.558	81.03	1:198.78
FS13	19400.200	3758191.285	121.892	120.255	1.637	25.14	1:359.86
FS16	19392.534	3758179.832	121.838	119.520	1.915	25.14	1:359.86
FS14	19371.888	3758174.899	121.788	119.274	1.910	25.14	1:359.86
FS15	19352.834	3758169.932	121.835	119.525	1.915	25.14	1:359.86
FS16	19331.830	3758161.750	119.018	117.488	1.550	44.88	1:277.86
FS17	19311.828	3758158.709	118.521	116.271	1.930	44.88	1:277.86
FS7A	19288.240	3758103.314	113.969	112.584	1.375	44.88	1:277.86
FS18	19248.820	3758141.718	114.972	113.472	1.500	53.51	1:169.94
FS19	19268.338	3758138.928	114.918	112.808	1.910	56.99	1:168.79
FS20	19277.827	3758134.410	114.168	112.260	1.945	79.00	1:139.79
FS21	19288.768	3758129.410	113.052	111.487	1.225	56.99	1:168.79
FS22	19288.820	3758144.120	112.417	110.852	1.569	16.07	1:168.79
FS23	19294.448	3758168.282	107.834	106.304	1.530	82.55	1:205.54
FS24	19242.207	3758208.872	102.801	101.265	1.535	82.55	1:193.01
FS48	19298.638	3758254.196	102.574	101.024	1.550	87.79	1:163.87
FS26	19200.126	3758168.500	122.161	120.511	1.650	50.01	1:202.28
FS28	19201.097	3758174.192	122.007	119.891	1.900	38.83	1:204.42
FS29	19203.521	3758169.274	119.868	117.452	2.355	34.84	1:114.84
FS28	19203.810	3758176.500	119.488	114.270	2.310	34.84	1:114.84
FS29	19204.298	3758182.125	119.378	114.171	1.900	35.97	1:163.89
FS29A	19204.724	3758171.883	113.890	112.885	1.025	20.43	1:181.71
FS30	19210.851	3758170.116	111.117	109.833	1.280	20.43	1:181.71
FS31	19218.928	3758168.265	109.528	108.964	1.000	20.00	1:298.95
FS32	19228.250	3758161.522	108.934	108.434	1.000	38.25	1:231.91
FS33	19232.870	3758159.410	108.128	107.816	1.510	33.98	1:144.96
FS47	19238.980	3758143.040	103.907	103.411	1.000	15.99	1:248.92
FS34	19240.871	3758138.244	117.745	116.519	1.230	15.99	1:248.92
FS35	19242.008	3758142.888	117.759	115.285	1.480	23.75	1:168.69
FS36	19232.870	3758141.855	117.477	115.971	1.200	23.75	1:168.69
FS37	19230.001	3758165.127	114.167	112.707	1.460	89.72	1:211.92
FS38	19238.121	3758164.061	113.470	112.000	1.470	45.06	1:171.71
FS41	19238.132	3758163.081	113.725	112.923	1.820	43.00	1:173.33
FS39	19230.827	3758170.752	119.975	114.373	1.300	80.26	1:132.34
FS40	19230.900	3758168.928	119.980	114.378	1.600	46.50	1:169.97
FS42	19241.828	3758161.928	109.505	108.969	1.540	42.94	1:173.71
FS43	19241.828	3758161.928	109.505	108.969	1.540	42.94	1:173.71
FS44	19248.222	3758159.220	108.359	107.800	1.050	16.31	1:211.15
FS45	19248.188	3758151.730	104.363	103.833	1.030	27.82	1:208.97
FS46	19248.188	3758151.730	104.363	103.833	1.030	15.61	1:173.71
FS47	19274.388	3758143.040	103.307	101.411	1.890	34.26	1:192.85
FS48	19282.958	3758140.188	102.974	101.824	1.150	11.76	1:169.80
FS49	19282.958	3758140.188	102.974	101.824	1.150	23.83	1:168.22
FS49A	19282.726	3758149.911	102.981	101.944	1.040	83.55	1:163.87
FS49	19282.556	3758144.001	108.788	107.144	1.645	11.76	1:169.80
FS50	19282.726	3758144.001	108.441	106.771	1.670	23.83	1:168.22
FS51	19284.938	3758138.152	107.842	105.911	2.322	83.55	1:163.87
FS52	19294.008	3758130.161	106.838	104.906	2.030	70.08	1:148.80
FS49	19282.726	3758144.001	108.396	106.821	1.530	44.88	1:168.84

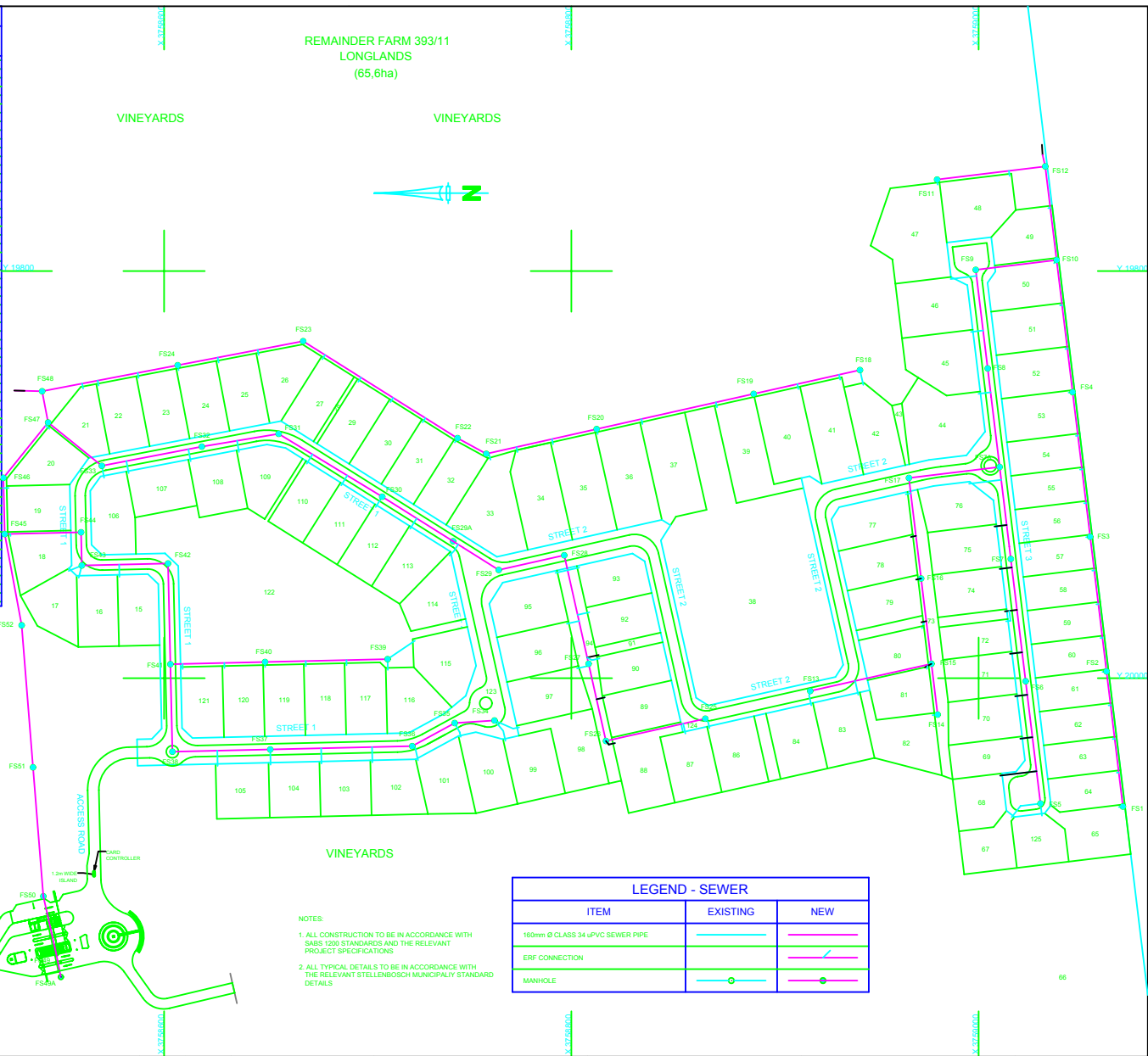

LEGEND - SEWER		
ITEM	EXISTING	NEW
160mm Ø CLASS 34 uPVC SEWER PIPE		
ERF CONNECTION		
MANHOLE		

NOTES:
 1. ALL CONSTRUCTION TO BE IN ACCORDANCE WITH SABS 1000 STANDARDS AND THE RELEVANT PROJECT SPECIFICATIONS.
 2. ALL TYPICAL DETAILS TO BE IN ACCORDANCE WITH THE RELEVANT STELLENBOSCH MUNICIPALITY STANDARD DETAILS.

Amendment		SCALE FOR REDUCED PLAN		Designed F.D		Consulting Engineer Pt Eng		Client		Project		Drawing description		Scale	
No.	Date	Checked	Drawn	Description		Drawn	EDW	Date	LONGLANDS HOLDINGS (Pty) Ltd	CIVIL ENGINEERING SERVICES FOR LONGLANDS COUNTRY ESTATE		SEWER LAYOUT		1:1000	
B	14/05/20	F.O.	F.O.	SEWER LAYOUT AMENDED										Date MAY 2009	
C	10/05/10	EDW	EDW	ACCESS ROAD ADDED AND SEWER AMENDED										Drawing number 20815BKS/03	
D	10/05/09	EDW	EDW	EXTERNAL SEWER NETWORK DRAWINGS											
E	12/01/09	EDW	EDW	SEWER NETWORK AMENDED											
F	11/01/11	EDW	EDW	AS BUILT											

P.O. Box 398
 Bellville 7535
 Tel: (021) 912-3000
 Fax: (021) 912-3022
 e-mail: capetown@kvl.co.za